



GHOX-F

CONTACT US

CIS Branch Email: blt.cis@bltcn.cn Tel: +86 24 25162836	Russia Branch Email: blt.russia@bltcn.cn Tel: +86 24 25162890	Middle East Branch Email: blt.mideast@bltcn.cn Tel: +86 24 25162854	Europe Branch Email: blt.europe@bltcn.cn Tel: +86 24 25162782
Southeast Asia Branch Email: blt.asia@bltcn.cn blt.asean@bltelevator.com Tel: +86 24 25162848	Brilliant Elevator(Singapore) Pte. Ltd. Email: blt.sg@bltcn.cn Tel: +86 24 25162563	BLT Peru S.A.C. Email: blt.peru@bltcn.cn Tel: +51 01 3204142	BLT Brilliant Co., Ltd Email: blt@yahoo.com Tel: 00976-99082518
India Branch(South Asia) Bang Ladech Email: blt.india@bltcn.cn Tel: +86 24 25162850	South America Branch Email: blt.southamerica@bltcn.cn blt.america@bltcn.cn Tel: +86 24 25162868	Africa Branch Email: blt.africa@bltcn.cn Tel: +86 24 25162858	Central America Branch Email: blt.centralamerica@bltcn.cn Tel: +86 24 25162769
Oceania Branch Email: blt.oceania@bltcn.cn Tel: +86 24 25162842	Service after sales Email: blt.service@bltcn.cn Tel: +86 24 25162952	Middle East Marketing Development Email: blt.kaifa@bltcn.cn Tel: +86 24 25162775	
Indo-China Peninsula Branch Email: blt.philippines@bltelevator.com Tel: +86 24 25162853	Russia Brach (Northern Asia) Email: blt.easternrussia@bltcn.cn Tel: +86 24 25162835	Southeast Asia Branch Email: jackyliu@bltcn.cn Tel: +86 24 25162767	



SHENYANG YUANDA INTELLECTUAL INDUSTRY GROUP CO., LTD.
Add:No.27,Development Road,Shenyang Economic&Technology
Development Zone,China P.C:110027
<http://www.bltelevator.com>



Meaning

"X" represents future , science and technology, concept, exploration,
and BLT's vision for the future of home elevators



New Concept

The most important thing for the success of any technological revolution is to have a fundamentally different way of thinking. In the past, present and future, X•HOMELIFT will change our perception of home elevators !

Nowadays, the real estate market is divided into several targeted products based on different user groups' characteristics and their respective pursuit of quality of life. The trend of segmented markets has driven the vigorous development of many supporting industries. In response to the differentiation of product functions, pricing, and demand brought about by this segmented market, the original commercial elevator system cannot adapt to the rapidly changing home elevator market, in terms of the product itself or the manufacturer's business model. Architectural forms such as townhouses, stacked buildings, large flat floors, duplex buildings and even self-built houses are constantly enriching the market. The original single concept of villas is rapidly changing to the level of household and intelligence. The concept of "X • HOMELIFT" came into being against such a background.



COMPANY PROFILE

Shenyang Yuanda Intellectual Industry Group Co., Ltd. is affiliated to Yuanda Enterprise Group. Its BLT Elevator is a professional company engaged in the design, manufacturing, installation and after-sales service of modern elevator products.

Listed company

On July 17, 2012, the company was successfully listed on the Shenzhen Stock Exchange (002689.SZ). Since then, BLT Elevator has stepped onto a new level and embarked on a new journey.

Quality system

Seeking reputation with quality control, seeking market with high-quality products, all management and control indicators have reached international advanced standards, a super-large elevator manufacturing base of 560,000 square meters, a 177-meter-high iconic full-featured elevator test tower, and the continuously improving production process of fully CNC intelligent products, 137 items of product quality inspection and control, more than 100 independent patents and international certification of products, ensure the safe operation of BLT elevator without accidents.

R & D capabilities

The "Yuanda BLT" elevator with independent intellectual property rights and independent brand has been already among the leading ranks in the global elevator industry achieving the perfect combination of the world's top technology, talents and first-class equipment, making BLT's main business continuously expand, and become a world-class technology research and development center and talent center in the same industry.

Dedicated to export

No matter in China or in the world, BLT has spread to every corner of the world with its excellent quality and extraordinary creativity, building a cutting-edge brand in the elevator industry in the technological era. BLT provides high-quality elevator products to more than 140 countries and regions, and provides comprehensive maintenance services for global customers.



PRODUCT ADVANTAGES

Adopt traditional gantry structure

Higher safety factor | More stable and reliable operation | Two counterweight arrangements (side, rear)

It is suitable for the installation of various residential products, the design of the minimum 150mm shallow pit, and the concept of making full use of the shaft space are extreme but reasonable

Roller guide shoe

Improve ride comfort, reduce friction between guide shoe and guide rail, save energy

Hydraulic buffer

The performance of the elevator is always the same throughout its life, without maintenance

A new generation of high-strength polyurethane composite steel strip

It has obtained the report of the National Elevator Quality Supervision and Inspection Center and the fatigue test certificate of 10 million times

150_{mm}
Ultra Shallow Pit Design

10_{million}
Times steel strip fatigue
test certificate

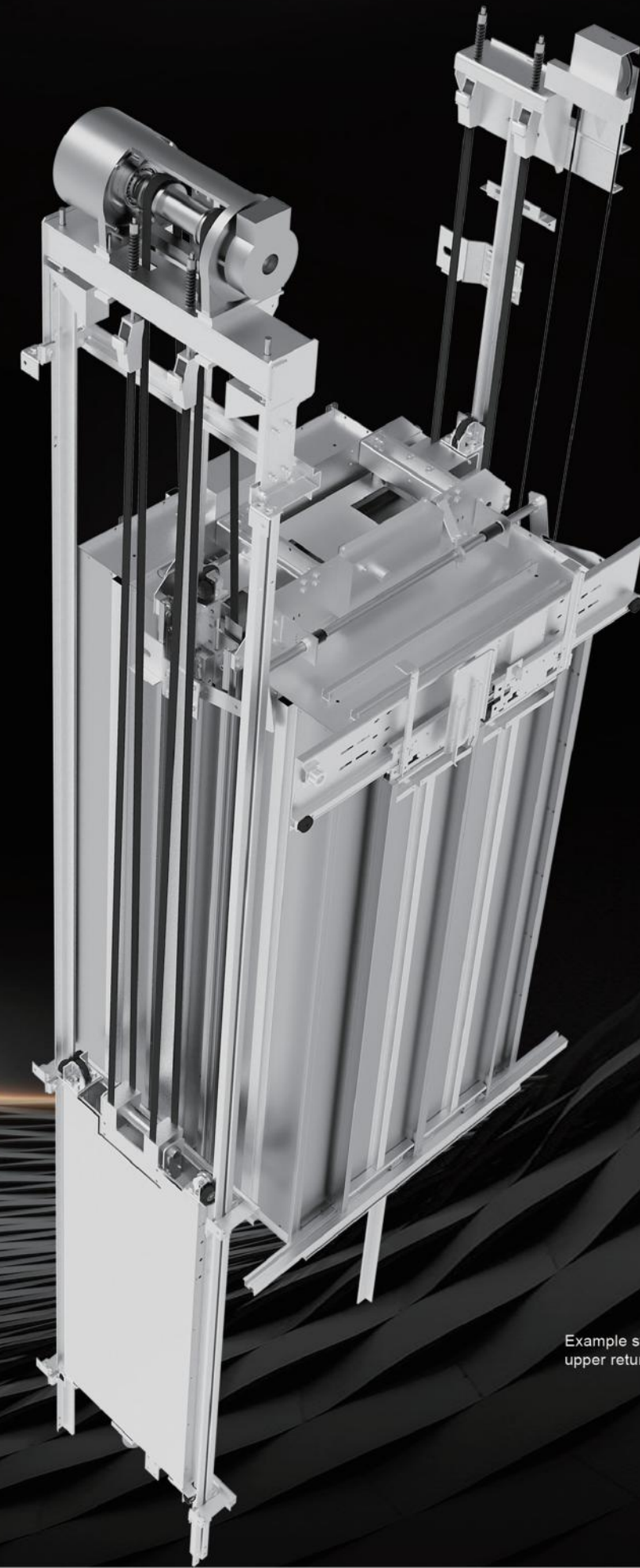

Example structure: GHOX-F side counterweight upper return rope type steel belt home elevator

Safety device system

Components maintenance-free system

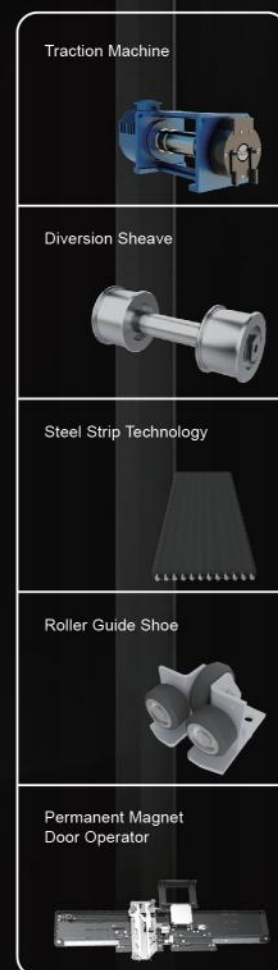

Headroom height(mm)=Car height+650mm

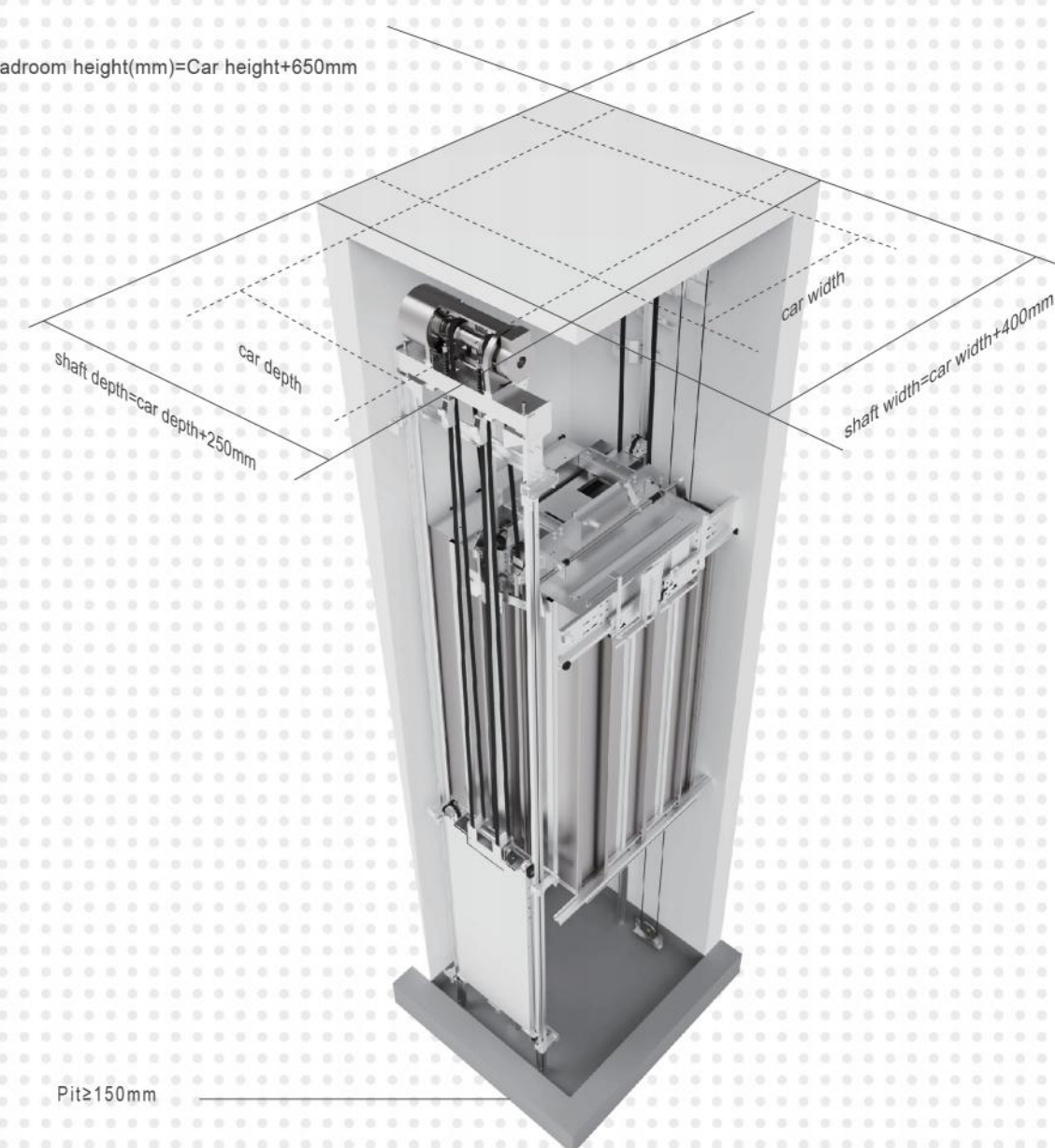

Note:Side counterweight structure, taking center-opening door as an example, regardless of door opening size

SPACE UTILIZATION

Extreme space utilization

BLT X•HOMELIFT is always committed to "reaching the maximum size in the limited space", the integrated car has a more compact structure, improving the utilization rate of shaft, meeting the requirements of small pit and solving the problem of insufficient height of headroom height of low-rise residential buildings

CONTROL SYSTEM

Enjoy a high-quality life.

X-CONTROL
with international certified STO
security control technology



Size: 0.5mH×0.3mW×0.16m D

- **Ingenuity and practicality**
Deep integration, MINI volume is only 30% of the traditional control cabinet,
- **Perfect integration of industry and home**
The control cabinet can be integrated into the overall design of decoration, and installation position is optional
- **Serenity guarding**
No contactor application, no fan design, control cabinet volume in line with suitable living environment standards
- **Enjoy a pleasant and comfortable life**
High performance drive platform with innovative algorithm completely solves the problem of elevator startup and operation comfort
- **Provide security for life**
With special star sealing scheme, there is no longer a safety risk of falling.
ARD power failure emergency rescue, electric brake release, car one key dialing rescue.

Integrated cabinet on car top
Product features: small size,
ultra-thin, more suitable for home elevator



ACTIVE SAFETY TECHNOLOGY

ACTIVE SAFETY, nip in the bud.



X-SAFE star sealing technology

Even in the most extreme state, the elevator will not stall, fundamentally eliminating falling accidents



X-IOT Internet of Things

Remote elevator management, big data statistical analysis of elevator failure rate, advance prediction of possible elevator failures



X-ARD Power failure rescue

The system ARD module automatically recognizes the status of the power grid. Once a power failure occurs, the elevator automatically levels nearby to ensure the safe departure of passengers

PASSIVE SAFETY TECHNOLOGY

Passive and active, more reliable and complete



X-AUTO RESCUE Automatic rescue

When faults occur and the system cannot operate normally, the system automatically enters the rescue mode, and automatically opens the door after running at a low speed to the leveling floor



X-PHONE One-key remote call

When someone is trapped in the car, dial the pre-stored phone number through the alarm button to achieve rescue

DECORATION DISPLAY

Note: Rendering pictures are for display only



H044



Car ceiling: PD069, hairline stainless steel, soft film ceiling LED light box

Rear wall: hairline stainless steel+mirror etched stainless steel(MSK-017)

Front wall, transom: hairline stainless steel

Car door: hairline stainless steel

Side walls: hairline stainless steel+mirror stainless steel(middle)

Floor: plastic FSJ-034

Handrail: aluminum alloy H026(fluorocarbon BYS3 gray)

Operation panel: black tempered glass touch panel, C225G

H045



MSK-018

H046



MSK-019

H047



MSK-016

H048



MSK-020

Materials available for selection, more options, please refer to our material catalog



Mirror stainless steel



Titanium black
mirror stainless steel



Titanium gold
mirror stainless steel



Rose gold mirror
stainless steel



Champagne gold
mirror stainless steel

Note: Rendering pictures are for display only

H036



Car ceiling: PD068, white wooden, champagne gold mirror decorative strip,

LED virtual light band, LED downlighter

Rear wall: wooden decorative wall (embedded mural)

Front wall, transom: wooden decorative wall

Car door: champagne gold mirror stainless steel

Side walls: wooden decorative wall (embedded mirror)

and champagne gold mirror stainless steel (middle)

Floor: plastic FSJ-031

Handrail: aluminum alloy H026 (fluorocarbon BYS5 champagne gold)

Operation panel: black tempered glass touch panel, C225G

H037



Car ceiling: PD069, painted steel sheet RAL9003, LED light box

Rear wall: champagne gold mirror etched stainless steel (MSK-026)

Front wall, transom: champagne gold hairline stainless steel

Car door: champagne gold hairline etched stainless steel (MSK-022)

Side walls: champagne gold hairline stainless steel and champagne gold mirror stainless steel (middle)

Floor: plastic FSJ-031

Handrail: aluminum alloy H026 (fluorocarbon BYS5 champagne gold)

Operation panel: black tempered glass touch panel, C225G

H038



Car ceiling: PD070, painted steel sheet RAL9003, mirror stainless steel frame, acrylic transparent plate, LED virtual light strip

Rear wall: hairline stainless steel and mirror etched stainless steel (MSK-024)

Front wall, transom: hairline stainless steel

Car door: hairline stainless steel

Side walls: hairline stainless steel and mirror stainless steel (middle)

Floor: plastic FSJ-032

Handrail: aluminum alloy H026 (fluorocarbon BYS3 gray)

Operation panel: black tempered glass touch panel, C225G

H039

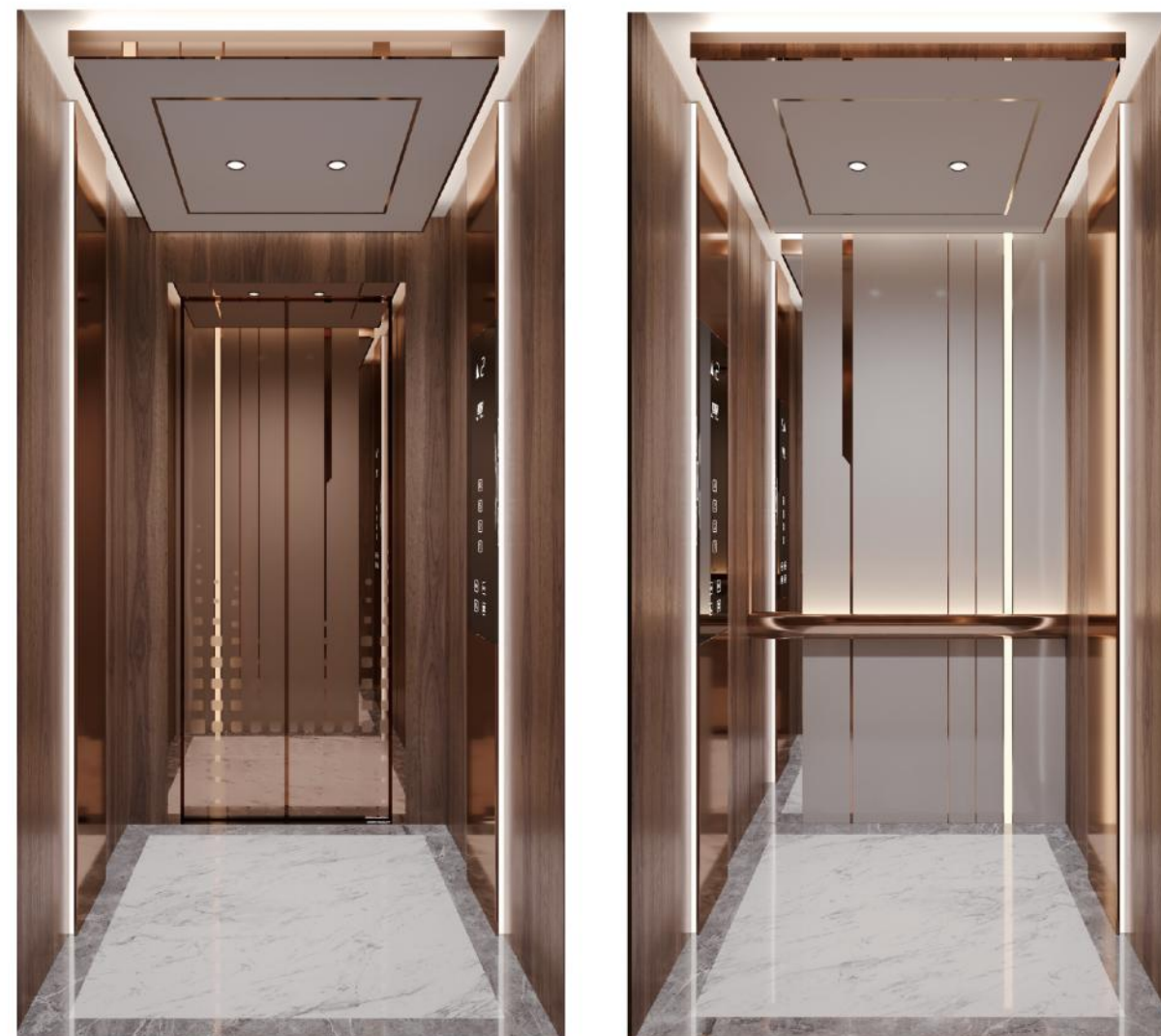

Car ceiling: PD071, painted steel sheet RAL9003, rose gold mirror frame and decorative strip, LED virtual light strip, LED down light

Rear wall: mirror stainless steel and mirror sandblasted stainless steel and LED light strip

Front wall, transom: wood grain steel plate

Car door: rose gold mirror etched stainless steel (MSK-025)

Side walls: wood grain steel plate and rose gold mirror stainless steel (middle)

Floor: plastic FSJ-033

Handrail: aluminum alloy H026 (fluorocarbon BYS4 rose gold)

Operation panel: black tempered glass touch panel, C225G

H040



Car ceiling: PD072, rose gold mirror stainless steel, LED virtual light strip, LED light strip

Rear wall: rose gold mirror stainless steel and wood grain steel plate and LED light strip

Front wall, transom: rose gold hairline stainless steel

Car door: rose gold mirror stainless steel

Side walls: rose gold hairline stainless steel and rose gold mirror stainless steel
(middle) and LED light strip

Floor: plastic FSJ-034

Handrail: aluminum alloy H026 (fluorocarbon BYS4 rose gold)

Operation panel: black tempered glass touch panel, C225G

H041



Car ceiling: PD073, titanium black mirror stainless steel frame, LED light box

Rear wall: mirror stainless steel and art glass and grille and LED light strip

Front wall, transom: wood grain steel plate

Car door: titanium black mirror stainless steel

Side walls: wood grain steel plate and titanium black mirror stainless steel (middle)

Floor: plastic FSJ-035

Handrail: aluminum alloy H026 (fluorocarbon BYS1 black)

Operation panel: black tempered glass touch panel, C225G

H042



Car ceiling: PD074, painted steel sheet RAL9003, LED virtual light strip, LED light strip

Rear wall: wood grain steel plate and art glass

Front wall, transom: wood grain steel plate

Car door: rose gold mirror etched stainless steel (MSK-023)

Side walls: wood grain steel plate and rose gold mirror stainless steel (middle)

Floor: plastic FSJ-036

Handrail: aluminum alloy H026 (fluorocarbon BYS4 rose gold)

Operation panel: black tempered glass touch panel, C225G

H043



Car ceiling: PD075, painted steel sheet RAL9003, champagne gold mirror frame, LED virtual light strip, LED down light.

Rear wall: grille and wood grain steel plate

Front wall, transom: wood grain steel plate

Car door: champagne gold mirror etched stainless steel (MSK-021)

Side walls: wood grain steel plate and champagne gold mirror stainless steel (middle)

Floor: plastic FSJ-037

Handrail: aluminum alloy H026 (fluorocarbon BYS5 champagne gold)

Operation panel: black tempered glass touch panel, C225G

FLEXIBLE DECORATION

Smart Construction Fully Reflects The Designer's Ability To Integrate Aesthetic Feeling

Landing/car door etched pattern



MSK-021



MSK-022



MSK-023



MSK-025

Car ceiling



PD068



PD069



PD070



PD071



PD072



PD073



PD074



PD075

Car floor

Marble



FSJ/DLS — 031

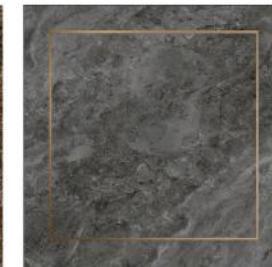

FSJ/DLS — 032



FSJ/DLS — 033



FSJ/DLS — 034



FSJ/DLS — 035



FSJ — 036



FSJ/DLS — 037



FSJ — 044 / DLS — 041

Handrail

Standard configuration of aluminum alloy handrail, hidden light belt design

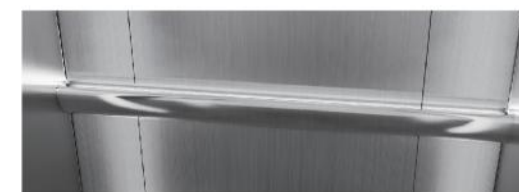

LED pedal

The entire series of products are equipped with LED pedals to add color to the car



MAN-MACHINE INTERACTIVE CONTROL

Use the elevator control system as a medium to enable communication between the user and the elevator



Elevator adopts
Sterilizing fresh air system

Effectively remove **PM2.5**

Protect the respiratory health of passengers

Control panel integrated fan control system



Note: Rendering pictures are for display only



C225G
(Side setting)



H241A



H243A



H245A



H253A



H244A



H246A
(standard configuration)

MAN-MACHINE



AUTOMATIC DOOR DESIGN

Change the color and material as you like, let X•HOMELIFT perfectly integrate into your home life

Door sheet material (example of center opening door, and some base materials)



White (painted steel sheet)



Hairline stainless steel



Mirror stainless steel



Rose gold mirror



Champagne gold



Titanium

Door configuration	Center opening automatic (CO)	Side opening automatic (2S)	Four panels center opening (2CO)
--------------------	-------------------------------	-----------------------------	----------------------------------

Please refer to the product specification for the selection of the door opening method according to the size of the shaft and selection of base materials other than display materials

Note: This is a rendering picture, just for illustration

FUNCTION INTRODUCTION



GENERAL OPERATION FUNCTION

- Collective selective control
- Door opening time setting
- Door service floor settings
- Light curtain protection
- Door independent control
- Door lock safety monitoring
- Landing at another floor
- Automatic main floor returning
- Wrong instruction cancelling function
- Service floor setting
- Self-rescue at low speed
- Startup torque automatic compensation
- Direct landing
- Record of running times
- Record of running time
- Overload protection
- Electric brake release
- Fault data record
- Through door



MAINTENANCE FUNCTION

- Maintenance running
- Motor parameters tuning
- Floor position intelligent correction
- Elevator running test



SAFETY FUNCTION

- Intelligence automatic rescue
- Power failure automatic rescue
- One-key remote rescue
- Main floor calibration



ENERGY SAVING CONFIGURATION

- Car energy saving
- Idle door machine energy saving
- Fan independent control

Note: Some of the above function lists are optional functions, and you can learn about specific function configurations with sales personnel

APPLICABLE CIVIL SHAFT PARAMETERS

The Dimensions Are Only For Design Reference, And The Details Are Subject To The Civil Engineering Layout Confirmed By Both Parties

Structural mode: side counterweight

Center opening automatic door, shaft plan

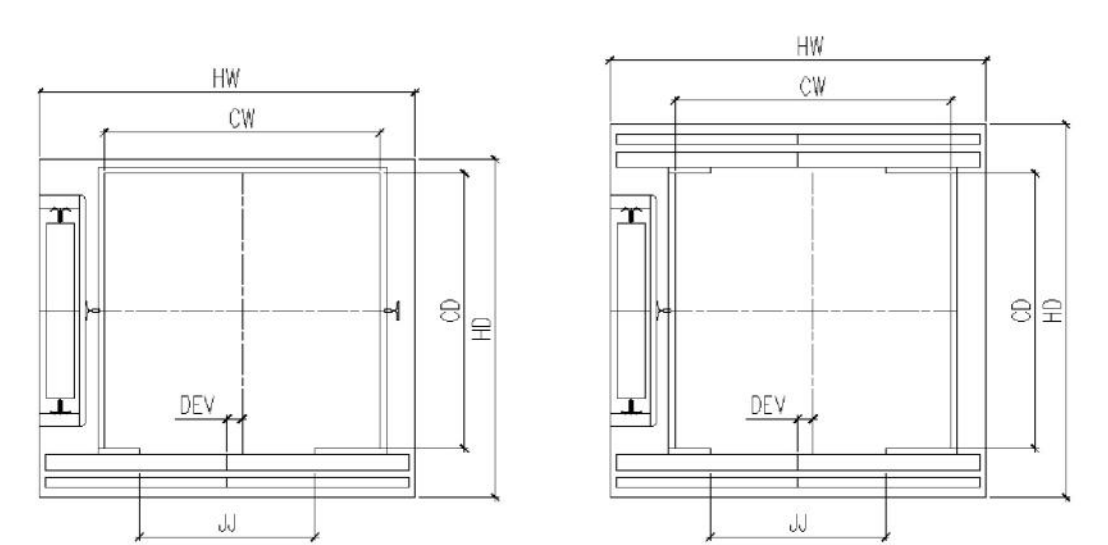

Rated load(kg)	320/400
Rated speed(m/s)	0.4
Car clear dimension(CWxCDxCCH)(mm)	[650,1300]×[700,1300]×[2000,2400]
Car door opening dimension(JJxHH)(mm)	CO [600,1200]×[2000,2300]
Shaft dimension(HWxHD)(mm)	HW=CW+400; HD=CD+250@ single door;HD=CD+390@ through door

- Note:
- CW&CD refers to the width and depth of the car structure, some decorations will occupy the space of the car, see the car decoration description for details.
 - Depending on the thickness of the decorative ceiling, the clear height of the car will be different. For details, please refer to the description of the decorative ceiling style.
 - When the marble floor is used, the clear height of the car is reduced by 20mm

Side opening automatic door, shaft plan

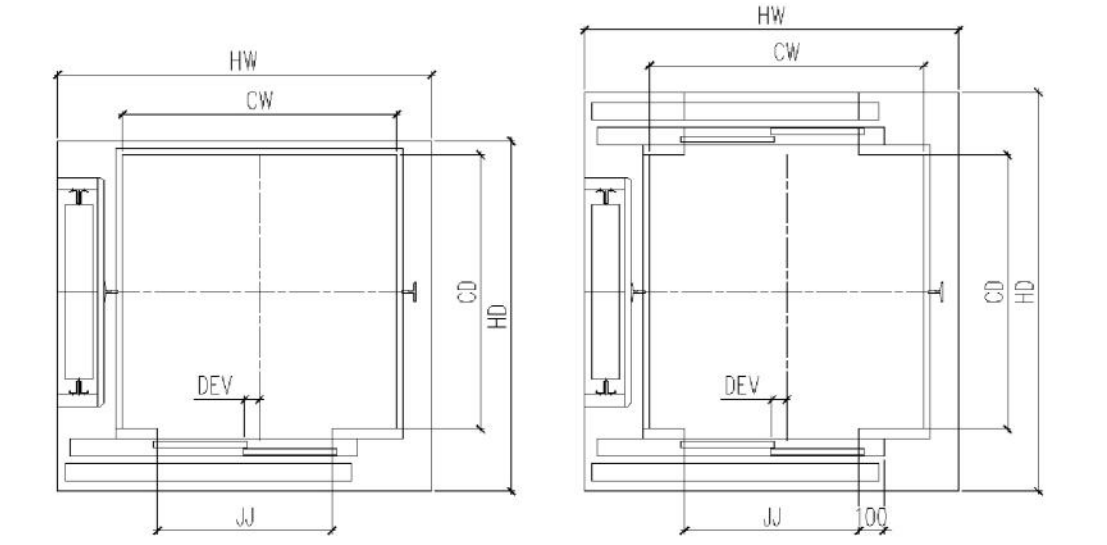

Rated load(kg)	320/400
Rated speed(m/s)	0.4
Car clear dimension(CWxCDxCCH)(mm)	[650,1300]×[700,1300]×[2000,2400]
Car door opening dimension(JJxHH)(mm)	2S [600,1200]×[2000,2300]
Shaft dimension(HWxHD)(mm)	HW=CW+400; HD=CD+305@ single door;HD=CD+500@ through door

- Note:
- CW&CD refers to the width and depth of the car structure, some decorations will occupy the space of the car, see the car decoration description for details.
 - Depending on the thickness of the decorative ceiling, the clear height of the car will be different. For details, please refer to the description of the decorative ceiling style.
 - When the marble floor is used, the clear height of the car is reduced by 20mm

Structural form: rear counterweight

Four panels center opening door ,Shaft plan

Center opening automatic door, shaft plan

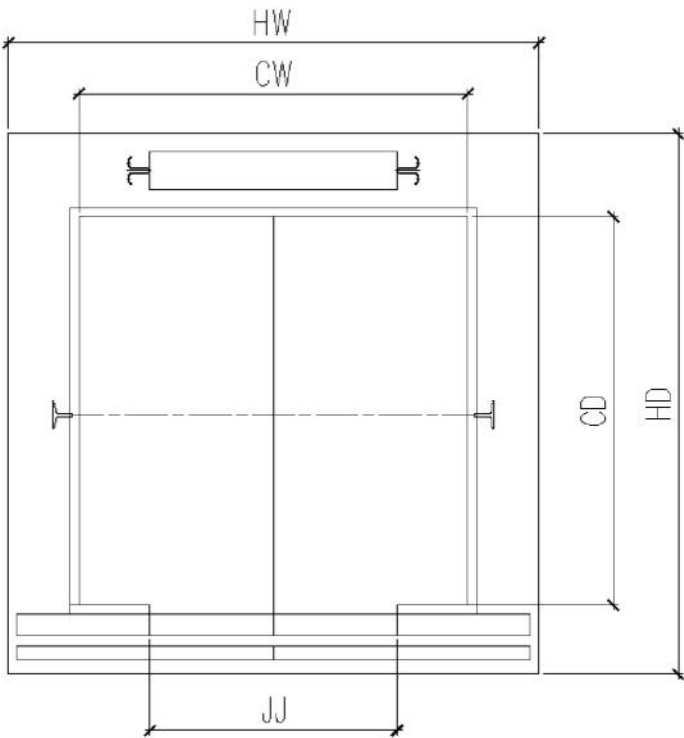
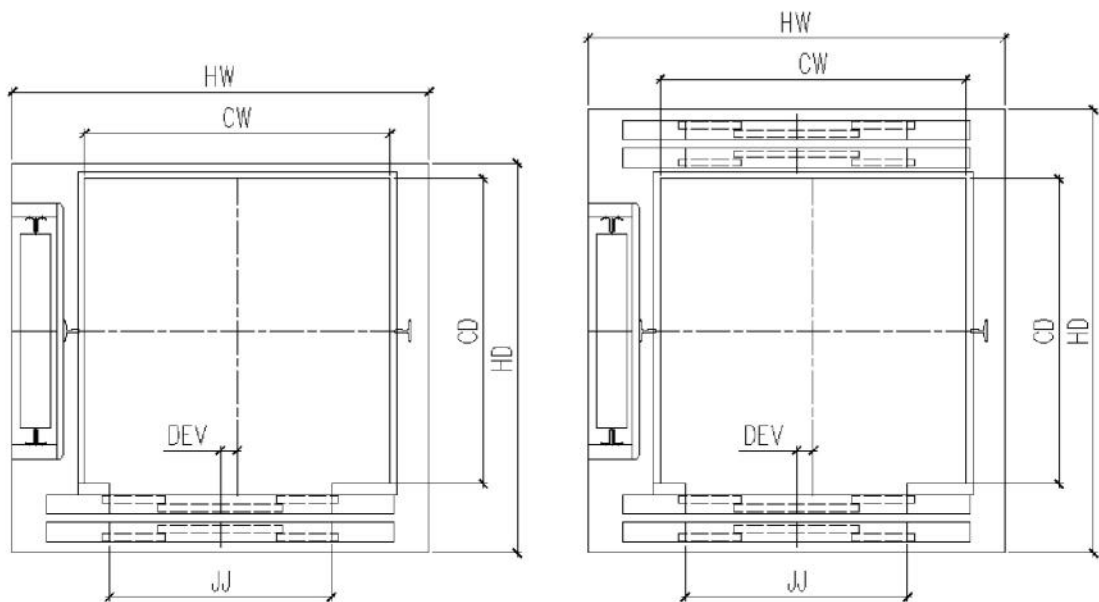

Rated load(kg)	320/400
Rated speed(m/s)	0.4
Car clear dimension(CWxCDxCCH)(mm)	[650,1300]×[700,1300]×[2000,2400]
Car door opening dimension(JJxHH)(mm)	2CO [600,1200]×[2000,2300]
Shaft dimension(HWxHD)(mm)	HW=CW+400; HD=CD+305@ single door;HD=CD+500@ through door

Rated load(kg)	320/400
Rated speed(m/s)	0.4
Car clear dimension(CWxCDxCCH)(mm)	[650,1300]×[700,1300]×[2000,2400]
Car door opening dimension(JJxHH)(mm)	CO [600,1200]×[2000,2300]
Shaft dimension(HWxHD)(mm)	HW=CW+300; HD=CD+430

- Note:
- 1. CW&CD refers to the width and depth of the car structure, some decorations will occupy the space of the car, see the car decoration description for details.
 - 2. Depending on the thickness of the decorative ceiling, the clear height of the car will be different. For details, please refer to the description of the decorative ceiling style.
 - 3. When the marble floor is used, the clear height of the car is reduced by 20mm

- Note:
- 1. CW&CD refers to the width and depth of the car structure, some decorations will occupy the space of the car, see the car decoration description for details.
 - 2. Depending on the thickness of the decorative ceiling, the clear height of the car will be different. For details, please refer to the description of the decorative ceiling style.
 - 3. When the marble floor is used, the clear height of the car is reduced by 20mm

The Dimensions Are Only For Design Reference, And The Details Are Subject To The Civil Engineering Layout Confirmed By Both Parties

Side opening automatic door, shaft plan

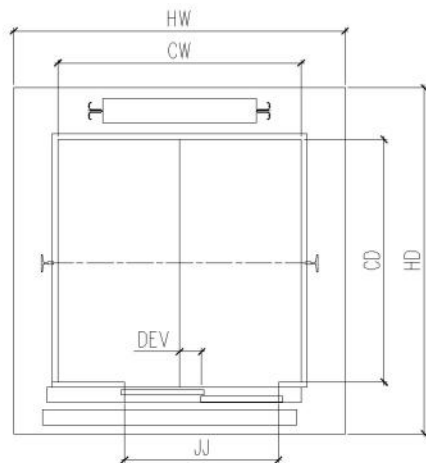

Rated load(kg)	320/400
Rated speed(m/s)	0.4
Car clear dimension(CWxCDxCCH)(mm)	[650,1300]×[700,1300]×[2000,2400]
Car door opening dimension(JJ×HH)(mm)	2S [600,1200]×[2000,2300]
Shaft dimension(HW×HD)(mm)	HW=CW+300；HD=CD+490

- Note:
- 1. CW&CD refers to the width and depth of the car structure, some decorations will occupy the space of the car, see the car decoration description for details.
 - 2. Depending on the thickness of the decorative ceiling, the clear height of the car will be different. For details, please refer to the description of the decorative ceiling style.
 - 3. When the marble floor is used, the clear height of the car is reduced by 20mm

Four panels center opening door , Shaft plan

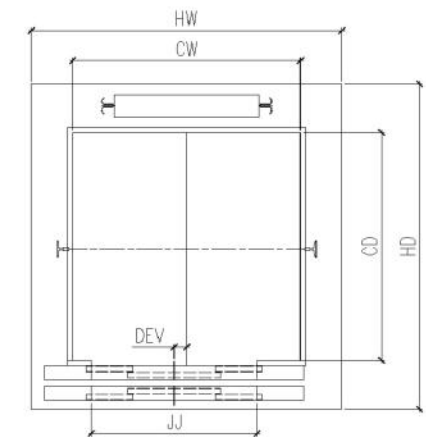

Rated load(kg)	320/400
Rated speed(m/s)	0.4
Car clear dimension(CWxCDxCH)(mm)	[650,1300]×[700,1300]×[2000,2400]
Car door opening dimension(JJ×HH)(mm)	2CO [600,1200]×[2000,2300]
Shaft dimension(HW×HD)(mm)	HW=CW+300；HD=CD+490

- Note:
- 1. CW&CD refers to the width and depth of the car structure, some decorations will occupy the space of the car, see the car decoration description for details.
 - 2. Depending on the thickness of the decorative ceiling, the clear height of the car will be different. For details, please refer to the description of the decorative ceiling style.
 - 3. When the marble floor is used, the clear height of the car is reduced by 20mm

Shaft Elevation

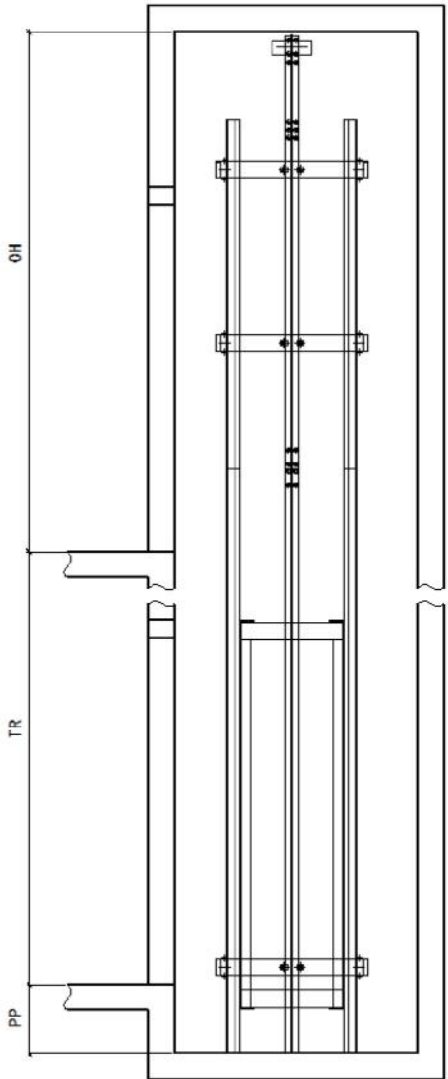

Rated load(kg)	320/400
Rated speed(m/s)	0.4
Lifting height TR(m)	≤12
Number of landings	2 ~ 7
Door clear height CH(mm)	2000-2300
Headroom height OH(mm)	CCH+600@side counterweight CCH+750@rear counterweight
Pit depth PP(mm)	150